

Cronus Video Door Phone

2-wire Series

Installation and User Manual

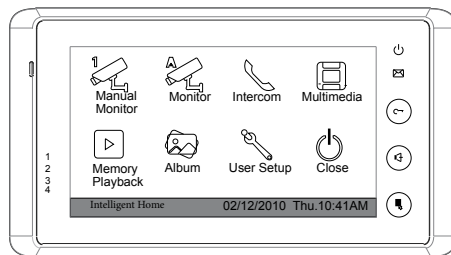

Image Recording Version

Digital Touch Screen 7 inch Monitor

PRECAUTIONS

- Read this manual thoroughly before using the product.
 - Slots or openings in the back of the monitor, are provided for ventilation and to ensure reliable operation of the video monitor or equipment and to protect it from overheating. These openings must not be blocked or covered. The monitor should never be placed near or over a radiator or heat register and should not be placed in a built-in installation such as a bookcase unless proper ventilation is provided.
 - All parts should be protected from violent vibration, impacts, knocking and dropping.
 - Clean the LCD monitor with Plastic Protection cleaner only.
 - Image distortion may occur if the video door phone is mounted too close to a magnetic field e. g. Microwaves, TV, computer etc.
 - Please keep away the video door monitor from wet, high temperature, dust, and caustic and oxidation gas in order to avoid any unpredictable damage.
 - Do NOT open the device. If there is a malfunction, call the administrator for help. Opening the device will invalidate the warranty.
-

CONTENT

1. Monitor Parts and Functions -----	1
2. Monitor Mounting -----	1
3. Installation -----	1
4. Connection of Peripheral Devices -----	2
5. Cable specification -----	3
6. Operating Instructions -----	4
7. Built-in Memory and SD Card -----	8
8. Specifications -----	10

1. Monitor Parts and Functions

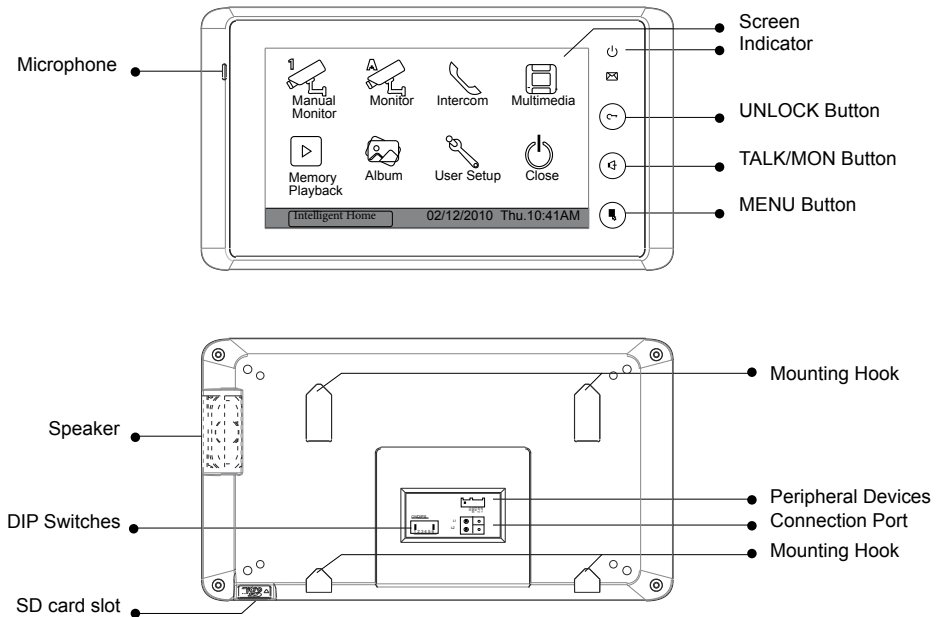

2. Monitor Mounting

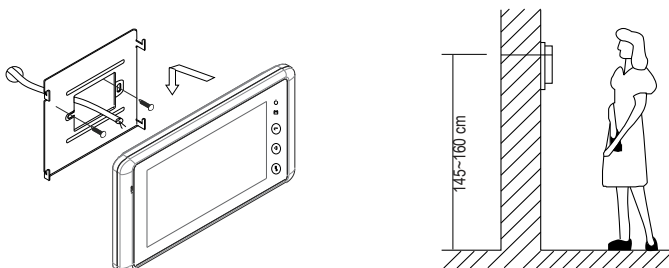

1. Use the screws to fix the mounting bracket on the wall;
2. Hang the Monitor on the mounting bracket firmly.

3. Installation

For connection diagram please refer to the door station manual.

4. Connection of Peripheral Devices

4.1 Additional Doorbell

Additional Door Bell can be connected according to the diagram below. There will be no video on the monitor when this door bell used.

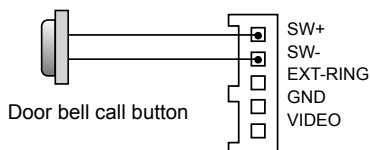

4.2 Additional Ringer

Additional Ringer can be connected according to the diagram below. One ringer per video monitor. Locate a ringer in a position where you are unlikely to hear the ringing of the monitors like a garage, shed, garden or porch.

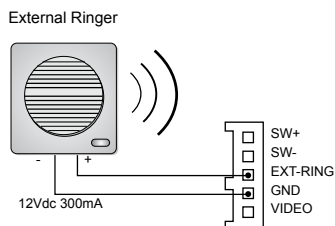

4.3 Connection To a TV

Each monitor can be connected to a TV with antenna cable according to the diagram below. The core of antenna cable must be connected to the Video and the shield to the GND. When the door station rings you don't have to walk to the monitor to see the visitor. Instead you can change AV channel on the TV and see who is calling on the TV screen.

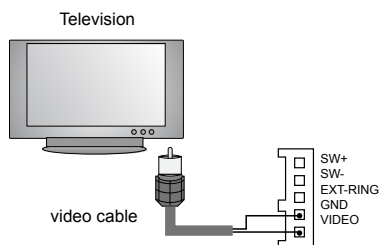

4.4 CCTV Interface

Up to 2 x CCTV cameras can be connected with one DCU CCTV Interface. This interface provides power to the CCTV cameras as well. Up to a three DCU CCTV Interfaces can be connected to support maximum six CCTV cameras. For connection diagram please refer to DCU manual.

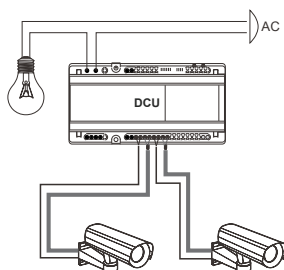

4.5 TPC Telephone Interface

TPC Telephone Interface Allows you to call-forward from a door station to a mobile phone or landline phone. One TPC Telephone Interface per house system required. For Flats system one TPC Telephone Interface per flat required. For connection diagram please refer to TPC telephone Interface manual.

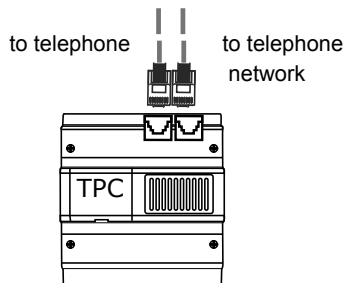

4.6 IPC IP Interface

IPC IP Interface Allows you to connect your door entry system to the Internet. Allows you to see and answer the door via web.

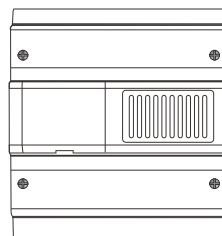



5. Cable specification

The best cable for this system is 2-wire twisted pair cable; 2-wire stranded core such as power flex cable or certain speaker cables. CAT5 or CAT6 can be used as well (not recommended) if all cores are paired up in two sets of cores.

Cable type	Max. distance(meters)
RVV 2 * 1.5 mm ²	300 (Non-shielded, Twisted)
RVV 2 * 1.0 mm ²	200 (Non-shielded, Twisted)
RVV 2 * 0.75 mm ²	150 (Non-shielded, Twisted)

6. Operating Instructions

6.1 Answering a Door Call

When door station rings the monitor comes on with video. To start conversation, touch  Talk/Monitor button or  Talk icon on the screen. To end conversation touch  Talk/Monitor button once again or, monitor will shut down automatically after 90s.



6.2 Multi Monitor System

Most multi-monitor systems contain one Image Recording monitor and a number of 'No Memory' monitors. By default the system is set to power saving mode which means that only the first monitor in the system (with code "zero") comes on with video when the door station is activated. All the other monitors will ring but without video. Video will be transferred instantly to the monitor which is used to answer the call.

If you would prefer to set ALL monitors to ring with video please do following: Enter the Main Menu by touching the screen anywhere; digital clock will open, touch the screen again.

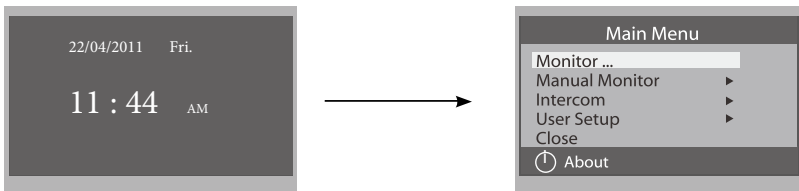

Touch the  "About" icon on the left hand side, at the bottom. Where you see the text in the middle of the screen, touch and HOLD for approximately 2s

Using the keypad, type in following code: 8006#.

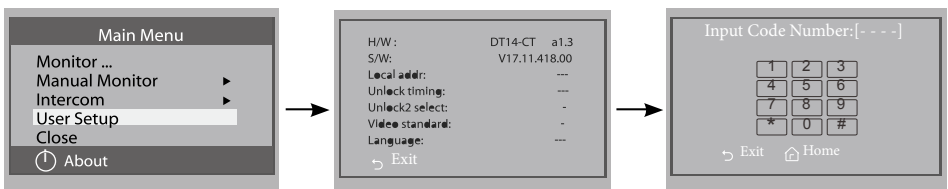

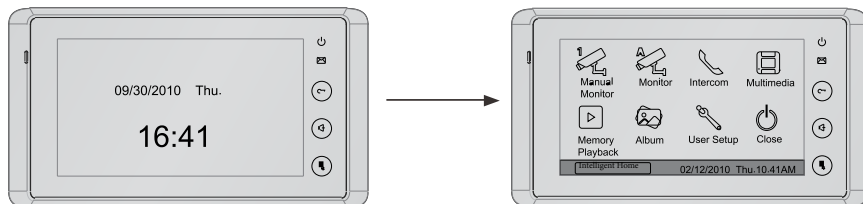

Repeat this process on ALL monitors in system. After completing all monitors, your system will ring with video.

Image Recording Monitor settings can be accessed similar way.

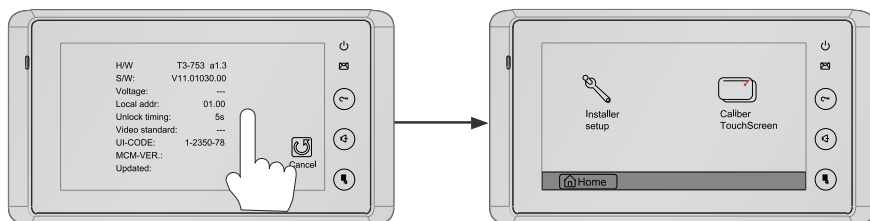

Touch "Intelligent Home" icon on the left hand side, at the bottom. Where you see the text in the middle of the screen, touch and HOLD for approximately 2s. Go to "Installer Setup".



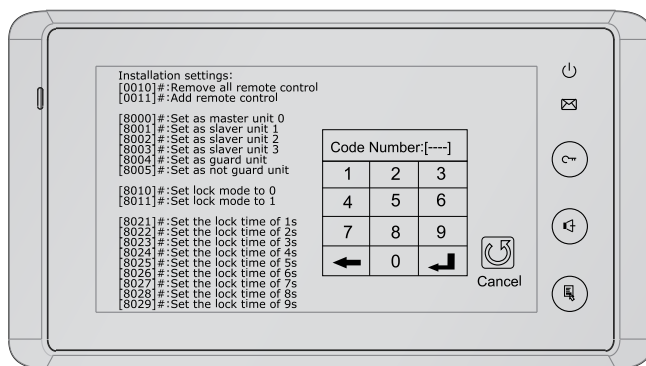

Using the keypad, program desired settings and press  icon to save it.



You may increase the power on the combined power supply if needed by adjusting power on the PS5 to a higher power (maximum 32V). If you feel that one power supply provides not enough power (depends on number of video monitors, additional devices and distances) you may need to add a second combined power supply.

6.3 Electric Lock Release

You can open the lock by touching  Lock icon on the monitor. There are two  icons Lock1 and Lock2 which means you can have up to 2 electric locks connected and opened independently.

When system connected to a lock, remember to set unlocking time and a lock mode. Enter the Main Menu by touching the screen anywhere; digital clock will open, touch the screen again. Touch the icon “Intelligent Home” on the left hand side, at the bottom. Where you see the text in the middle of the screen, touch and HOLD. Go to 'Installer Setup'. Using the keypad, type in following codes:

8010 # for Power-on-to open lock;

8011 # for Power-off-to open lock.

Next step to set the unlocking time between 1~9s, codes 8021~8029#.

Type 8021 # for 1s unlocking time, 8029 for 9s unlocking time.

6.4 Manual and Auto Monitoring

You can see the outside any time even nobody rings the bell, even if nobody rings the bell. To do so, open the Main menu and find icons “Manual Monitoring”- mainly for house system and “Auto Monitoring” - mainly for Flats/Apartment system. Manual monitoring allows choosing door station or CCTV cameras (if connected) manually.

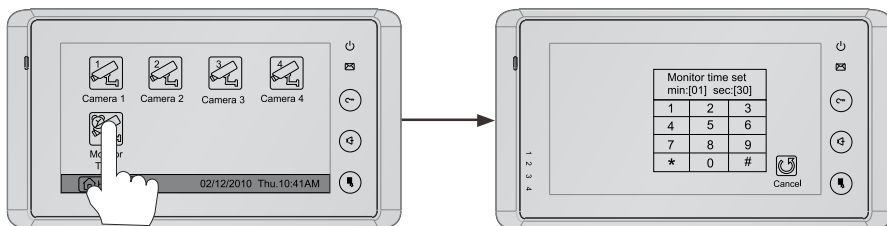

Camera 1 represents the main door station.



Camera 2 could be second door station or DCU CCTV Interface with two CCTV cameras connected.



Camera 3 could be third door station or DCU with two CCTV cameras.



Camera 4 could be forth door station or DCU with two CCTV cameras.

When CCTV monitored manually it will work the following way: for example  Camera 2 is connected to a DCU with two CCTV cameras, so it will show video from CCTV cameras switching between two of them every 20 sec for as long as monitoring time was set.

Auto monitoring will show in sequence all door stations/CCTV cameras connected with time interval was set by additional software. To set the monitoring time for “Manual Monitoring” please do following: go to Main menu and then to Manual Monitoring. You will see the  Monitoring Time. Using the digital keypad set desired monitoring time following by #. Monitoring time could be set for a maximum 99min 99s.

6.5 Intercom Function

There are two types of Intercom between monitors. Each one of them depends on system settings. Please decide before you do the programming, which way you prefer.

TYPE 1. Intercom by “Name list” allows you to call to a specific monitor in the system. Programming should be done by DIP switches. Name list could be created with additional software which is a little bit complicated. Monitor numbers could be used instead of names. You will have to memorise or make a note what number represents which room.

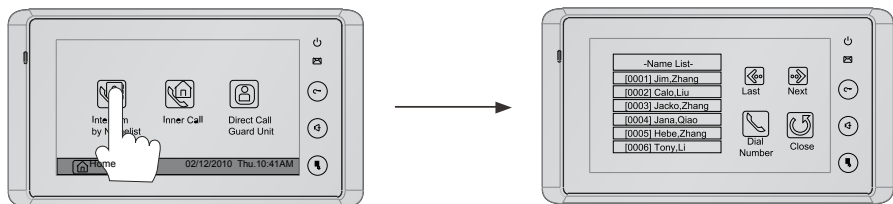

TYPE 2. Intercom “Inner Call” when you started a call from one of the monitors, then all monitors in the system will ring. Programming should be done via menu (Master, Slave monitors)





6.6 Ring Tone Settings

Touch  User setup icon on the main menu and you will see different ring tones for door station, Intercom, Day and Night rings which can be selected and saved.

6.7 Screen Settings

Screen settings, such as brightness, colour, scene and talk volume are accessible when the monitor is in monitoring state. Touch  Talk/Monitor button and then the  Adjust icon. Change parameters as desired and save your settings.

6.7 Restore to Factory Default

Touch  User setup icon on the main menu and then  Restore to Default icon. Clock settings and pictures stored will not be affected by restoring to the factory default.

7. Built-in Memory and SD Card

Cronus Image Recording version has been equipped with an internal memory (about 120 Mb, enough to store approximately 800 pictures) together with a SD card reader which supports Micro SD card for a maximum 16 Gb.

7.1 Image Recording

Auto Recording: When someone rings the doorbell, the monitor takes a picture (default) or series of pictures automatically. To change default setting, open the Main menu and find Multi Media icon. Then touch the Memory icon and you will see a digital keypad. The options are: 1/4/8 pictures taken every 1.5s. All other digits are invalid. Press # to save your setting.

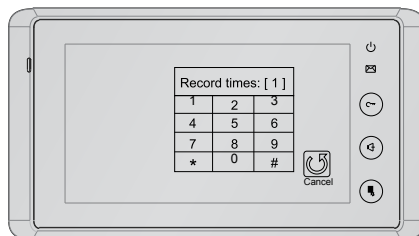

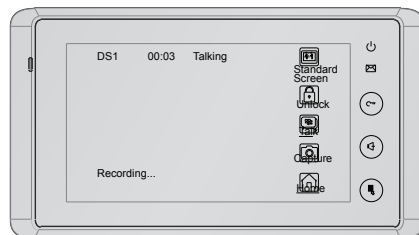

Manual Recording: can be initiated at any time manually. To do so touch the Capture icon while monitoring the door station or a CCTV camera and it will be recorded.



7.2 Pictures Playback

To see recorded pictures open the Main menu

and then touch  **Memory Playback** icon.

Touch  and  icon to scroll the pictures,

touch  **Delete** icon to delete selected

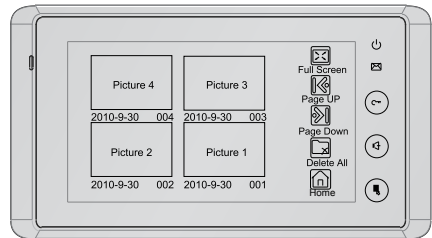

pictures or touch  to delete all pictures.

Touch  **Zoom** icon to zoom selected pictures.



Pictures stored in the internal memory can be copied onto the SD card. To do so, open the "Main menu" and then touch  **Multimedia** icon. Put SD card into card reader slot and then touch **Memory to SD** icon. To view the pictures on your PC you have to convert pictures recorded by monitor in TVS format to a JPG format. T-views Photo software should be used. Software can be downloaded from our website from "Manuals" section. Software contains two tools, T-views Memo and T-views Album. To transfer pictures from your monitor, use T-views Memo. Make sure the SD card is inserted in your PC or laptop before you start work. Select the pictures (press Ctrl+A to select all) -->click the right key of the mouse - -->choose transfer selected to JPG item - -->save the pictures on computer.

7.2 Pictures Playback

T-views Album tool should be used to create picture albums which can be played on your monitor using the Picture Frame feature. To do so create an album in software importing JPG pictures (maximum 800) and copy them onto SD card. To set Picture Frame time parameters open the Main menu and then touch  **Multimedia** icon and then  **Album Options** icon. Using digital keypad type the time you want picture frame to play your pictures (maximum 99 min 99s) followed by # to save settings.

To use Picture frame feature, open the Main menu then touch  **Album** icon. Pictures will be played automatically with speed of loading determined by pixel size. Each picture will be displayed for 5 seconds. Use your finger to slide left/right to view pictures manually. Picture Frame will be interrupted by door station calling.

IMPORTANT: avoid putting in, or removing SD card under operation. This may damage SD card and internal memory chip.

8. Specification

- Power consumption: Standby 15mA; Working status 400mA
- Monitor screen: 7 Inch TFT-LCD Touch screen
- Display Resolutions: 800 x 480pixels
- Built-in Memory: 120 MB >800 pcs
- Picture Memo: >30000pcs(2G SD card)
- Monitor Dimension: H125 □ W225 □ D23 mm

[illegible]

WARRANTY CARD

NB Please keep this document safe, as it is proof of your Warranty.

Your Video door system comes with a one year Manufacturers Warranty. When used normally, the following services are offered:

1. Replacement for malfunctioning parts in first three months
2. Repair free of charge for malfunctioning parts in first year

The following actions will void the Warranty:

1. Damage to the device during installation
2. Damage to the device through misuse
3. Opening and/or disassembling the device
4. Attempting to force the device to perform functions for which it is not intended
5. Attaching the device to power supplies other than those recommended by the manufacturer

Distributor for Warranty purposes:

Intelligent Home Online Ltd.

62 Hartley Old Road

Purley

Surrey

CR8 4HJ

+44 (0)20 86170015

sales@intelligenthomeonline.com

www.intelligenthomeonline.com

Product: _____

Purchaser Name: _____

Invoice No : _____

Purchase Date _____



Cronus 2-wire V1 2012-08-11

The design and specifications can be changed without notice to the user.
Right to interpret and copyright of this manual are preserved.