

DX471 Firmware Update

This guide is to help you to upgrade DX471 via SD card and ST-Link

Updates in 03-DEC-2019 V1.6.9

- Fixes Wi-Fi offline bugs
- Fixes SIP time out when Wi-Fi is working
- Improves “PPT” press to talk and “Image flow” (check V1.6.8 for details)

Update your monitor

You could update your monitor either via Internet or offline via SD card

1. Online Update

Online update requires firmware version V1.6.0 or above and **SD card in the monitor**

Tap “settings” -> “Installer” -> next page -> “FW upgrade”

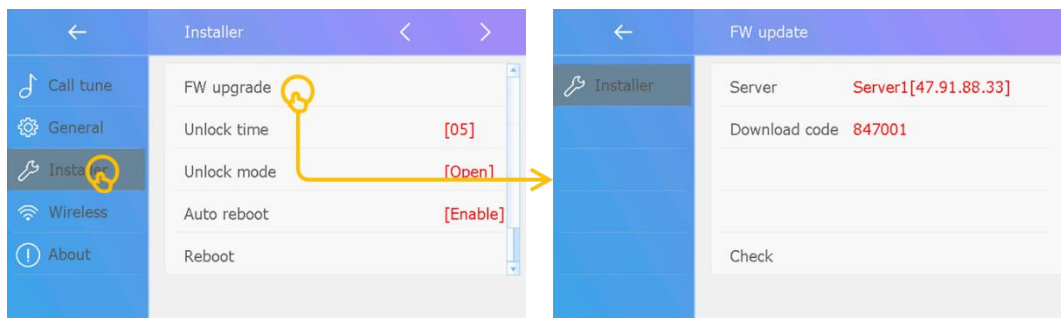

Server	Download code
Server1[47.91.88.33]	847100

Depends on current firmware version of your monitor, you might have or don't have Server info and Download code filled in. If not present, input server and download code, tap “Check” to update

After update system will reboot automatically.

After reboot check in “Settings” -> “About”, “S/W Ver: V1.6.9.19XXXXXXXXXX” means DX471 got latest firmware version

2. Offline update via SD card

Please download firmware before: (“DX471_FwUpdate” whole folder)

Stand English Version (1.6.9): <https://1drv.ms/u/s!AhpqXnqP9XIIIDonXE0ybz2xGD56?e=TIhspm>

- a. Extract and copy whole folder “DX471_FwUpdate” directly to the root directory of micro SD card no more than 32G

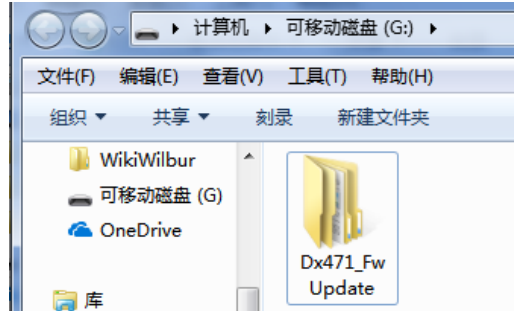

- b. Insert SD card as below picture shows:



- c. Power on the monitor and wait until booting finished, go to “Settings” -> “General” -> “SD card”, choose “Firmware Update”
- d. With long beep, indicator light turns red and flashes. Please do not power off. Upgrade might take 2-3 minutes
- e. After update, with long beep indicator light turns green, and system will reboot automatically. After reboot go to “Settings” -> “About”, “S/W Ver: V1.6.9.19XXXXXXXXXX” means monitor got latest firmware version
- f. Initialize by “Settings” -> “General” -> “Restore to default” -> “Restore factory default”

**If monitor cannot power up after update or abnormal, please contact support for USB tool update.*

Update your App

Scan to update or download latest APP on your mobile, or search “2easy” in App store or Google Play



After installation, disable IPV6

Tap top left corner, “Settings” -> “Network” -> disable “IPV6”

New Functions

To enable Press to talk or JPEG transfer as below:

Tap top left corner, “Settings” -> “Video” -> Enable “Auto check video receive” and “JPEG Transfer”

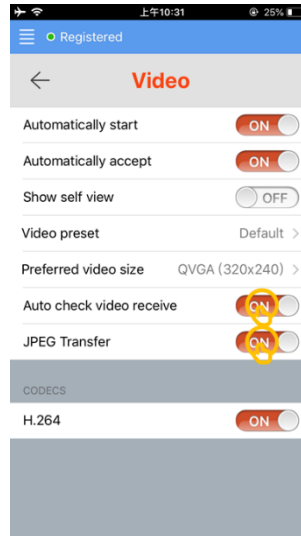

1. JPEG Transfer

JPEG Transfer is self-adaptive, system will decide whether using video or image flow base on current network communication

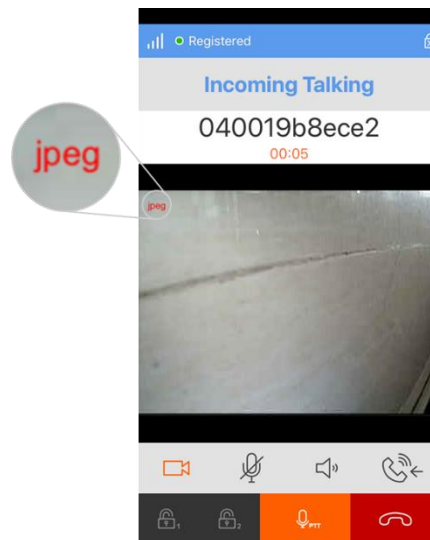

When a “JPEG” on top left of camera view, means monitor now are transferring Image instead of video

2. Press to Talk

Before press “PTT” on below when receiving calls, system is automatically switch audio channel as usual.

Automatic audio switch is under development, press “PTT” to turn the system into a “Press to Talk” . Press and hold “PTT” to talk, release “PTT” to listen.

If system in “Press to Talk”, you will see the icon in the top middle of camera view as pictured

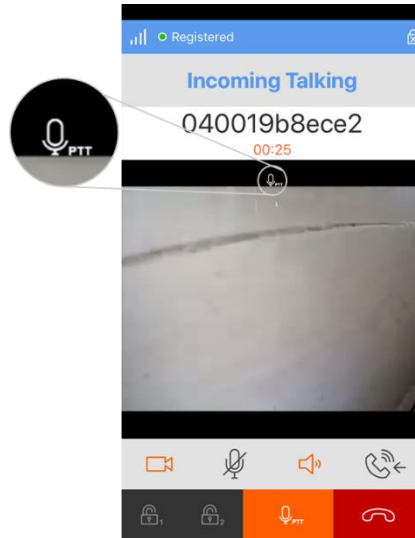

Release Note

Updated 08/Nov/2019 V1.6.9

1. Fix bug, Wi-Fi offline by no reasons
2. Fix bug, SIP offline when network is fine.

Updated 23/Sep/2019 V1.6.8

1. Added PTT function, press to talk
2. Added static image flow when network is unstable

Updated 14/Mar/2019 V1.6.3

1. Simultaneous call on monitor and APP
2. Online Update (Firmware upgrade via internet)
3. Eliminate data noise when talk start and end
4. Wi-Fi auto-reconnect mechanism improve, reconnect every 15mins.

Updated 02/Dec/2018 V1.6.0

1. Fixed system halt down problem in previous V1.5.3, V1.5.4 versions
2. Fixed Date and Time incorrect display bug
3. Improved Wi-Fi connection adaptability
4. Improved SIP call divert reliability
5. Improved when divert fail, will return to normal call ring
6. Improved Manual registration operation, will show failure reasons
7. Rearranged items of SIP config menu
8. Add SIP toolset for auto testing and statistics
9. Add menu items of Door Stations lock settings
10. Add Internet time sync control menu
11. Add Auto reboot option, for long time running stability
12. Add setting for call ring timing
13. Speed up screen on time
14. Delete local phone menu items
15. Delete call record together with picture memory